

Roller Followers:

Roller Follower also known as Yoke Type Track Roller bearings. Roller follower are designed for rotation of the outer ring in which a needle roller and cage assembly are fitted in the thick-walled outer ring.

Suffix and Corresponding Description for Roller Followers	
Suffix	Description of Suffix
X	Cylindrical Outer Diameter
2ZL	Sealing Shield With Lamellar Rings On Both Sides Of The Track Roller
PP	Plastic Axial Plain Washer With Formed Seal Lip On Both Sides Of The Yoke Type Track Roller, Giving a Three-Stage Seal.
2RS	Double Single Side Synthetic Rubber Seal
C2	Radial Internal Clearance C2 (Clearance less than CN)
CN	Radial Internal Clearance CN (Clearance Lager than C2)
C3	Radial Internal Clearance C3 (Clearance Lager than Normal)
C4	Radial Internal Clearance C4 (Clearance Larger than C3)
P6	JIS Class 6
P5	JIS Class 5
P4	JIS Class 4

Roller Followers : Yoke Type Roller
Bearing Track Rollers



Roller Followers : Yoke Type Roller
Bearing Track Rollers

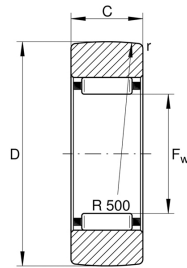

RSTO

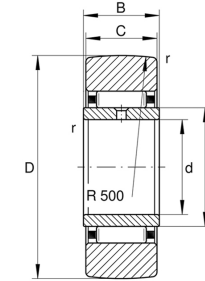

STO

Boundary Dimensions				Basic Load Rating		Limiting Speed	Bearing Designation	Mass Approx
(mm)				(KN)				
D	F _w	C	r (min)	Cr	Cor	(rpm)		(g)
16	7	7.8	0.3	2.55	2.60	16000	RSTO5	8.5
19	10	9.8	0.3	3.75	4.55	10000	RSTO6	12.5
24	12	9.8	0.3	4.20	5.50	8000	RSTO8	21
30	14	11.8	0.3	8.40	9.30	5500	RSTO10	42
32	16	11.8	0.3	9.00	10.30	4500	RSTO12	49
35	20	11.8	0.3	9.10	10.90	3300	RSTO15	50
40	22	15.8	0.3	14.20	17.90	2800	RSTO17	88
47	25	15.8	0.3	16.10	21.70	2400	RSTO20	130
52	30	15.8	0.3	16.40	23.20	1800	RSTO25	150
62	38	19.8	0.6	23.10	35.00	1300	RSTO30	255
72	42	19.8	0.6	25.00	40.50	1100	RSTO35	375
80	50	19.8	1	23.70	39.50	850	RSTO40	420
85	55	19.8	1	25.00	43.50	750	RSTO45	453
90	60	19.8	1	25.50	46.00	650	RSTO50	481

Boundary Dimensions						Basic Load Rating		Limiting Speed	Bearing Designation	Mass Approx
(mm)						(KN)				
D	F	C	d	B	r (min)	Cr	Cor	(rpm)		(g)
19	10	9.8	6	10	0.3	3.75	4.55	10000	STO6	17
24	12	9.8	8	10	0.3	4.20	5.50	8000	STO8	26
30	14	11.8	10	12	0.3	8.40	9.30	5500	STO10	49
32	16	11.8	12	12	0.3	9.00	10.30	4500	STO12	57
35	20	11.8	15	12	0.3	9.10	10.90	3300	STO15	63
40	22	15.8	17	16	0.3	14.20	17.90	2800	STO17	107
47	25	15.8	20	16	0.3	16.10	21.70	2400	STO20	152
52	30	15.8	25	16	0.3	16.40	23.20	1800	STO25	177
62	38	19.8	30	20	0.6	23.10	35.00	1300	STO30	308
72	42	19.8	35	20	0.6	25.00	40.50	1100	STO35	441
80	50	19.8	40	20	1	23.70	39.50	850	STO40	530
85	55	19.8	45	20	1	25.00	43.50	750	STO45	576
90	60	19.8	50	20	1	25.50	46.00	650	STO50	617

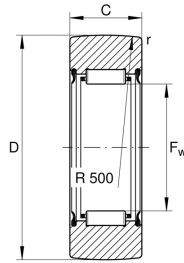

RNA22
With Seal 2RS

Boundary Dimensions				Basic Load Rating		Limiting Speed	Bearing Designation	Mass Approx
(mm)				(KN)				
D	F _w	C	r (min)	Cr	Cor	(rpm)		(g)
19	10	11.8	0.3	3.90	3.70	9000	RNA22/6.2RS	18
24	12	11.8	0.3	4.80	4.30	7000	RNA22/8.2RS	29
30	14	13.8	0.6	7.00	6.90	5500	RNA2200.2RS	52
32	16	13.8	0.6	7.50	8.30	4700	RNA2201.2RS	57
35	20	13.8	0.6	7.60	9.80	3400	RNA2202.2RS	60
40	22	15.8	1	9.90	14.00	3000	RNA2203.2RS	94
47	25	17.8	1	14.00	19.10	2300	RNA2204.2RS	152
52	30	17.8	1	14.40	20.80	1800	RNA2205.2RS	179
62	35	19.8	1	17.10	26.00	1400	RNA2206.2RS	284
72	42	22.7	1.1	21.50	36.00	1100	RNA2207.2RS	432
80	48	22.7	1.1	26.00	41.00	850	RNA2208.2RS	530

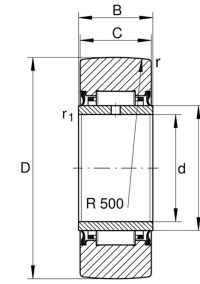

NA22
With Seal 2RS

Boundary Dimensions							Basic Load Rating		Limiting Speed	Bearing Designation	Mass Approx
(mm)							(KN)				
D	F	C	d	B	r (min)	r ₁ (min)	Cr	Cor	(rpm)		(g)
19	10	11.8	6	12	0.3	0.3	3.90	3.70	9000	NA22/6.2RS	22
24	12	11.8	8	12	0.3	0.3	4.80	4.30	7000	NA22/8.2RS	34
30	14	13.8	10	14	0.6	0.3	7.00	6.90	5500	NA2200.2RS	60
32	16	13.8	12	14	0.6	0.3	7.50	8.30	4700	NA2201.2RS	67
35	20	13.8	15	14	0.6	0.3	7.60	9.80	3400	NA2202.2RS	75
40	22	15.8	17	16	1	0.3	9.90	14.00	3000	NA2203.2RS	112
47	25	17.8	20	18	1	0.3	14.00	19.10	2300	NA2204.2RS	177
52	30	17.8	25	18	1	0.3	14.40	20.80	1800	NA2205.2RS	209
62	35	19.8	30	20	1	0.3	17.10	26.00	1400	NA2206.2RS	324
72	42	22.7	35	23	1.1	0.6	21.50	36.00	1100	NA2207.2RS	505
80	48	22.7	40	23	1.1	0.6	26.00	41.00	850	NA2208.2RS	628
90	58	22.7	50	23	1.1	0.6	26.00	43.00	650	NA2210.2RS	690

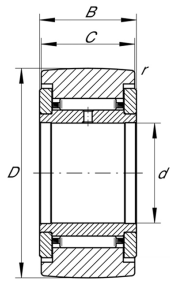

NATR (R=500 mm)
With Gap Seal

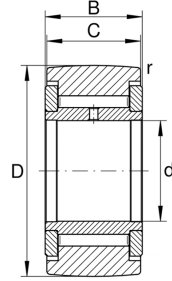

NATV (R=500 mm)
With Gap Seal

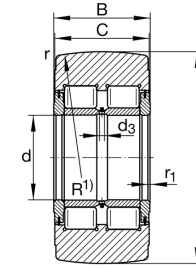

NNTR
With Seal 2ZL

Boundary Dimensions					Basic Load Rating		Limiting Speed	Bearing Designation	Mass Approx	Bearing Designation	Mass Approx
(mm)					(KN)						
d	D	B	C	r (min)	Cr	Cor	(rpm)		(g)		(g)
5	16	12	11	0.15	3.15	3.35	14000	NATR5	14	NATR5PP	14
5	16	12	11	0.15	4.90	6.60	3800	NATV5	15	NATV5PP	15
6	19	12	11	0.15	3.50	4.00	11000	NATR6	20	NATR6PP	19
6	19	12	11	0.15	5.40	8.00	3100	NATV6	21	NATV6PP	21
8	24	15	14	0.3	5.50	6.60	7500	NATR8	41	NATR8PP	38
8	24	15	14	0.3	7.80	11.60	2500	NATV8	42	NATV8PP	41
10	30	15	14	0.6	6.80	8.60	5500	NATR10	64	NATR10PP	64
10	30	15	14	0.6	9.50	14.90	2100	NATV10	65	NATV10PP	64
12	32	15	14	0.6	7.00	9.00	4500	NATR12	71	NATR12PP	66
12	32	15	14	0.6	9.70	15.70	1800	NATV12	72	NATV12PP	69
15	35	19	18	0.6	9.70	14.30	3600	NATR15	101	NATR15PP	95
15	35	19	18	0.6	12.60	23.10	1600	NATV15	109	NATV15PP	101
17	40	21	20	1	10.90	15.80	2900	NATR17	144	NATR17PP	139
17	40	21	20	1	14.70	26.50	1400	NATV17	152	NATV17PP	147
20	47	25	24	1	15.40	26.00	2400	NATR20	246	NATR20PP	236
20	47	25	24	1	20.30	42.00	1300	NATV20	254	NATV20PP	245
25	52	25	24	1	15.30	27.00	1800	NATR25	275	NATR25PP	271
25	52	25	24	1	20.20	44.00	1000	NATV25	285	NATV25PP	281
30	62	29	28	1	23.20	39.00	1300	NATR30	470	NATR30PP	444
30	62	29	28	1	30.00	62.00	850	NATV30	481	NATV30PP	468
35	72	29	28	1.1	24.80	44.50	1000	-	-	NATR35PP	547
35	72	29	28	1.1	32.50	71.00	750	-	-	NATV35PP	630
40	80	32	30	1.1	32.00	58.00	850	-	-	NATR40PP	795
40	80	32	30	1.1	40.00	88.00	650	-	-	NATV40PP	832
50	90	32	30	1.1	31.00	59.00	650	-	-	NATR50PP	867
50	90	32	30	1.1	39.00	92.00	550	-	-	NATV50PP	969

Boundary Dimensions							Basic Load Rating		Limiting Speed	Bearing Designation	Mass Approx
(mm)							(KN)				
d	D	B	C	d ₃	r (min)	r ₁ (min)	Cr	Cor	(rpm)		(kg)
50	130	65	63	3	3	2	193	265	1100	NNTR50X130X65-2ZL	5.2
55	140	70	68	4	3	2	226	315	850	NNTR55X140X70-2ZL	6.4
60	150	75	73	4	3	2	255	365	800	NNTR60x150x75-2ZL	7.8
65	160	75	73	5	3	2	280	395	700	NNTR65X160X75-2ZL	8.8
70	180	85	83	5	3	2	355	510	600	NNTR70X180X85-2ZL	13
80	200	90	88	5	4	2	415	610	500	NNTR80X200X90-2ZL	16.8
90	220	100	98	5	4	2.5	500	750	400	NNTR90X220X100-2ZL	22.5
100	240	105	103	6	4	2.5	560	870	340	NNTR100X240X105-2ZL	28
110	260	115	113	6	4	2.5	670	1050	300	NNTR110x260x115-2ZL	35.6
120	290	135	133	8	4	3	880	1400	260	NNTR120X290X135-2ZL	52.8
130	310	146	144	8	5	3	1010	1630	240	NNTR130X310X146-2ZL	65.2

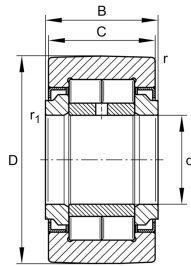

NUTR
With Labyrinth Seal

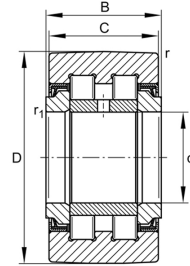

PWTR
With Seal 2RS

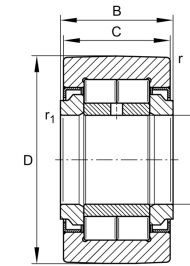

NUTR
With Labyrinth Seal

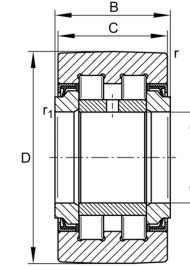

PWTR
With Seal 2RS

Boundary Dimensions						Basic Load Rating		Limiting Speed	Bearing Designation	Mass Approx
(mm)						(KN)				
D	d	B	C	r (min)	r ₁ (min)	Cr	Cor	(rpm)		(g)
35	15	19	18	0.6	0.3	15.30	18.70	6500	NUTR15	99
35	15	19	18	0.6	0.3	12.60			PWTR15.2RS	99
40	17	21	20	1	0.5	18.70	24.90	5500	NUTR17	147
40	17	21	20	1	0.5	14.30	17.90	5000	PWTR17.2RS	147
42	15	19	18	0.6	0.3	18.30	24.30	6500	NUTR1542	158
42	15	19	18	0.6	0.3	14.70	16.20	6000	PWTR1542.2RS	158
47	17	21	20	1	0.5	21.60	30.50	5500	NUTR1747	220
47	17	21	20	1	0.5	15.90	18.40	5000	PWTR1747.2RS	220
47	20	25	24	1	0.5	28.50	37.50	4200	NUTR20	245
47	20	25	24	1	0.5	24.50	30.50	3800	PWTR20.2RS	245
52	20	25	24	1	0.5	32.00	44.00	4200	NUTR2052	321
52	20	25	24	1	0.5	27.00	35.00	3800	PWTR2052.2RS	321
52	25	25	24	1	0.5	29.00	40.50	4200	NUTR25	281
52	25	25	24	1	0.5	25.00	33.00	3800	PWTR25.2RS	281
62	25	25	24	1	0.5	35.50	54.00	4200	NUTR2562	450
62	25	25	24	1	0.5	30.00	42.50	3800	PWTR2562.2RS	450
62	30	29	28	1	0.5	40.00	55.00	2600	NUTR30	465
62	30	29	28	1	0.5	35.00	45.50	2200	PWTR30.2RS	465
72	30	29	28	1	0.5	48.00	70.00	2600	NUTR3072	697
72	30	29	28	1	0.5	41.00	56.00	2200	PWTR3072.2RS	697
72	35	29	28	1.1	0.6	45.00	65.00	2100	NUTR35	630
72	35	29	28	1.1	0.6	38.50	54.00	1800	PWTR35.2RS	630
80	35	29	28	1.1	0.6	51.00	78.00	2100	NUTR3580	836
80	35	29	28	1.1	0.6	43.50	63.00	1800	PWTR3580.2RS	836
80	40	32	30	1.1	0.6	56.00	80.00	1600	NUTR40	816
80	40	32	30	1.1	0.6	45.00	61.00	1500	PWTR40.2RS	816
85	45	32	30	1.1	0.6	56.00	83.00	1400	NUTR45	883
85	45	32	30	1.1	0.6	45.50	63.00	1300	PWTR45.2RS	883
90	40	32	30	1.1	0.6	66.00	101.00	1600	NUTR4090	1129
90	40	32	30	1.1	0.6	52.00	75.00	1500	PWTR4090.2RS	1129

Boundary Dimensions						Basic Load Rating		Limiting Speed	Bearing Designation	Mass Approx
(mm)						(KN)				
D	d	B	C	r (min)	r ₁ (min)	Cr	Cor	(rpm)		(g)
90	50	32	30	1.1	0.6	56.00	86.00	1300	NUTR50	950
90	50	32	30	1.1	0.6	46.00	66.00	1100	PWTR50.2RS	950
100	45	32	30	1.1	0.6	72.00	115.00	1400	NUTR45100	1396
100	45	32	30	1.1	0.6	56.00	85.00	1300	PWTR45100.2RS	1396
110	50	32	30	1.1	0.6	76.00	128.00	1300	NUTR50110	1690
110	50	32	30	1.1	0.6	59.00	94.00	1100	PWTR50110.2RS	1690

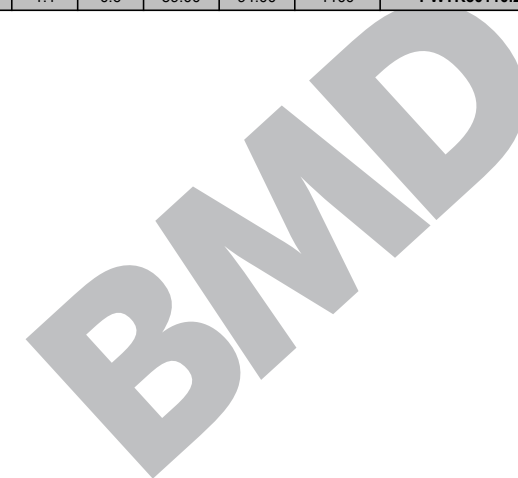

Roller Followers : Yoke Type Track Rollers
(Inch Series)



Roller Followers : Yoke Type Track Rollers
(Inch Series)

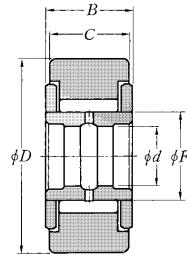

Type NACV..X
(Full complement)

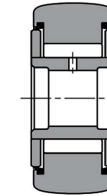

Type NACVPP
(Full complement sealed type)

Boundary Dimensions					Basic Load Rating		Load Rating of Truck		Limiting speed		Bearing Designation		Mass Approx (kg) NACV..X
(mm)					(KN)		(KN)		(rpm)		Type NACV..X	Type NACV..PP	
D	B	C	d	F _w	Cr	Cor			Oil	Grease			
19.050(3/4)	14.288(9/16)	12.700(1/2)	6.350(1/4)	11	8.05	13.30	4.60	1.38	11000	9000	NACV12X	NACV12XPP	0.027
22.225(7/8)	14.288(9/16)	12.700(1/2)	6.350(1/4)	11	8.05	13.30	5.35	1.71	11000	9000	NACV14X	NACV14XPP	0.036
25.400(1)	17.462(11/16)	15.875(5/8)	7.938(5/16)	14	11.70	18.90	7.40	2.06	9200	7100	NACV16X	NACV16XPP	0.059
28.575(1 1/8)	17.462(11/16)	15.875(5/8)	7.938(5/16)	14	11.70	18.90	8.35	2.43	9200	7100	NACV18X	NACV18XPP	0.073
31.750(1 1/4)	20.638(13/16)	19.050(3/4)	9.525(3/8)	18.47	17.70	35.00	11.40	2.84	7000	5400	NACV20X	NACV20XPP	0.109
34.925(1 3/8)	20.638(13/16)	19.050(3/4)	9.525(3/8)	18.47	17.70	35.00	12.50	3.25	7000	5400	NACV22X	NACV22XPP	0.132
38.100(1 1/2)	23.812(15/16)	22.225(7/8)	11.112(7/16)	21	21.10	45.50	16.30	3.60	6200	4800	NACV24X	NACV24XPP	0.177
41.275(1 5/8)	23.812(15/16)	22.225(7/8)	11.112(7/16)	21	21.10	45.50	17.60	4.05	6200	4800	NACV26X	NACV26XPP	0.218
44.450(1 3/4)	26.988(1 1/16)	25.400(1)	12.700(1/2)	24.65	28.40	60.50	21.60	4.40	5300	4100	NACV28X	NACV28XPP	0.281
47.625(1 7/8)	26.988(1 1/16)	25.400(1)	12.700(1/2)	24.65	28.40	60.50	23.20	4.85	5300	4100	NACV30X	NACV30XPP	0.327
50.800(2)	33.338(1 5/16)	31.750(1 1/4)	15.875(5/8)	26.71	41.00	87.50	31.00	5.30	4800	3700	NACV32X	NACV32XPP	0.454
57.150(2 1/4)	33.338(1 5/16)	31.750(1 1/4)	15.875(5/8)	26.71	41.00	87.50	35.00	6.20	4800	3700	NACV36X	NACV36XPP	0.585
63.500(2 1/2)	39.688(1 9/16)	38.100(1 1/2)	19.050(3/4)	31.15	54.50	119.00	44.50	7.20	4100	3200	NACV40X	NACV40XPP	0.902
69.850(2 3/4)	39.688(1 9/16)	38.100(1 1/2)	19.050(3/4)	31.15	54.50	119.00	49.00	8.25	4100	3200	NACV44X	NACV44XPP	1.05
76.200(3)	46.038(1 13/16)	44.450(1 3/4)	25.400(1)	36.85	76.50	177.00	64.00	9.15	3500	2700	NACV48X	NACV48XPP	1.39
82.550(3 1/4)	46.038(1 13/16)	44.450(1 3/4)	25.400(1)	36.85	76.50	177.00	69.00	10.00	3500	2700	NACV52X	NACV52XPP	1.66
88.900(3 1/2)	52.388(2 1/16)	50.800(2)	28.575(1 1/8)	44.5	84.50	214.00	86.00	11.10	2800	2200	NACV56X	NACV56XPP	2.19
101.600(4)	58.738(2 5/16)	57.150(2 1/4)	31.750(1 1/4)	44.5	106.00	244.00	112.50	13.20	2800	2200	NACV64X	NACV64XPP	3.22
127.000(5)	73.025(2 7/8)	69.850(2 3/4)	44.450(1 3/4)	68.7	189.00	520.00	165.50	17.90	1900	1500	NACV80X	NACV80XPP	6.08
152.400(6)	85.725(3 3/8)	82.550(3 1/4)	57.150(2 1/4)	81.35	260.00	675.00	239.50	22.10	1500	1200	NACV96X	NACV96XPP	10.0